



Sleepy Hollow Raneleigh Barns

Down Thomas, Plymouth, PL9 0DY

£415,000



Sleepy Hollow is a delightful barn conversion located in the ever popular Raneleigh development in Down Thomas. It is set in a wonderful rural location but still accessible to Plymouth & Plymstock. Wembury Point and the surrounding coastline is not too far away. The accommodation is laid out over 3 levels & is well-presented throughout. On the top level is a double bedroom with ensuite shower room & adjoining room. On the middle level are 2 further bedrooms, master ensuite & family bathroom whilst on the entrance level is the open-plan living area leading into the kitchen. The property is fully-furnished to include all furniture, TVs & white goods. Located in the nearby bloc is the garage. No onward chain.



SLEEPY HOLLOW, DOWN THOMAS, PL9 0DY

ACCOMMODATION

Access to the property is gained via the glazed entrance door leading into the living room.

LIVING ROOM 18'2" x 15'11" (5.56 x 4.86)

Double-glazed window to the front elevation. Turning staircase rising to the first floor. Under-stairs storage cupboard. Feature 'Living Flame' fire with wooden mantel surround providing a lovely focal point. Deep-sill window with slate sills. Opening leading into the kitchen.

KITCHEN 15'11" x 7'4" incl kitchen units (4.86 x 2.25 incl kitchen units)

Traditionally-styled matching eye-level and base units with wooden work surfaces and tiled splash-backs. Built-in breakfast bar area. Inset one-&a-half bowl sink unit with mixer tap. Built-in 4-ring gas hob with an electric oven beneath and extractor hood above. Space and plumbing for washing machine and dishwasher. Wall-mounted gas boiler. Recessed double-glazed window with a deep slate sill to the front elevation.

FIRST FLOOR LANDING

Further stairs rising to the second floor accommodation. Window to the rear elevation. Doors providing access to the first floor accommodation.

BEDROOM ONE 17'9" x 11'8" (5.43 x 3.58)

A dual aspect room with double-glazed windows to both front and rear elevations. Both windows are deep-silled with slate sills and exposed timber lintels above. Laminate floor. Elevated level. Doorway leading to the ensuite shower room.

ENSUITE SHOWER ROOM 7'6" x 2'5" (2.29 x 0.74)

Comprising a corner shower cubicle with a tiled area surround and shower unit with spray attachment, sink unit with a vanity cupboard beneath and a low level toilet. Extractor.

BEDROOM THREE 12'4" x 8'4" (3.76 x 2.56)

Double-glazed window to the front elevation. The window is deep-silled with slate sills and exposed timber lintel above. Laminate floor.

FAMILY BATHROOM 7'4" x 6'2" (2.24 x 1.88)

Modern suite comprising a 'P-shaped' bath with a tiled area surround, curved shower screen, mixer tap and electric shower unit with spray attachment, pedestal wash basin with mixer tap and a low level toilet. Tiled floor. Built-in extractor.

SECOND FLOOR

Turning staircase rising from the main landing leading up into the centre of a room.

SECOND FLOOR ROOM 12'5" x 8'5" taken at a height of 4'11" (3.80 x 2.57 taken at a height of 1.5)

Sloping ceilings to both the front and rear elevations. 2 velux-style double-glazed windows to the rear elevation. Exposed timber beams. Laminate floor. Eaves storage to both sides. Doorway leading into bedroom two.

BEDROOM TWO 9'9" x 8'3" taken at a height of 4'11" (2.98 x 2.54 taken at a height of 1.5)

Sloping ceilings to both the front and rear elevations. Velux-style double-glazed windows to the rear elevation. Laminate floor. Eaves storage. Doorway leading into the ensuite.

ENSUITE SHOWER ROOM 5'4" x 2'9" (1.63 x 0.86)

Comprising a shower cubicle with tiled area surround and shower unit with spray attachment, sink unit and a low level toilet. Tiled floor.

OUTSIDE

The property is located within a lovely converted barn development where there are communal garden areas. There is a sitting area to the front of the property. Located in one corner of the development is the garage bloc where the property has a garage.

AGENT'S NOTE

The owners are willing to include within the sale price a number of items that are in situ at the property subject to suitable negotiation.

COUNCIL TAX

South Hams District Council
Council tax band D

SERVICES

The property is connected to mains water and electricity. There is LPG heating and a septic tank for drainage.

LOCATION

The development is approached via a private road and is situated within the former grounds of the historic Langdon Court, which was mentioned in the Doomsday Book and with many notable owners including the Marquis of Exeter and subsequently Catherine Parr in 1564. The development is conveniently located close to local amenities such as a pub and shop in Down Thomas, a golf club and marina nearby as well as further amenities in Wembury and Plymstock. Plymouth city centre is only six miles away. The scenic South West coast path is only a mile away and is easily reached via the public footpath just off the private road. The coast path has been designated as a site of special scientific interest being part of the Wembury conservation area acquired by The National Trust.

Area Map



Floor Plans

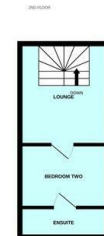
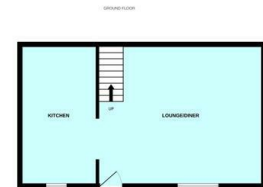

Made with Mergim 0205

Energy Efficiency Graph

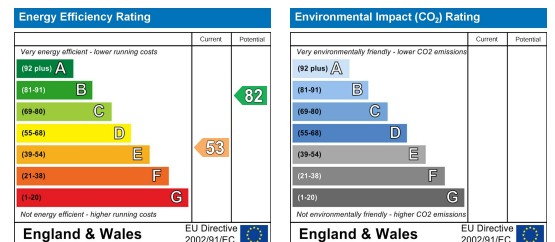

These particulars, whilst believed to be accurate are set out as a general outline only for guidance and do not constitute any part of an offer or contract. Intending purchasers should not rely on them as statements of representation of fact, but must satisfy themselves by inspection or otherwise as to their accuracy. No person in this firm's employment has the authority to make or give any representation or warranty in respect of the property.